

CLÉXI

# User Manual

2021

# First Time Registration

1. Get the Cléxi app from the Google play store or App Store (You can scan the QRCode).



2. Open the app, login with your preferred method (Google, Apple, Facebook).

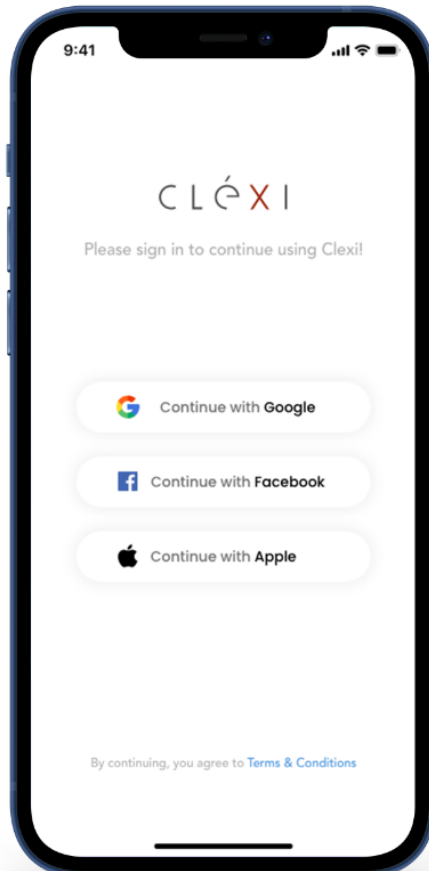

3. Connect your Cléxi to a device (Laptop, TV, phone, ...), Cléxi should start blinking red.

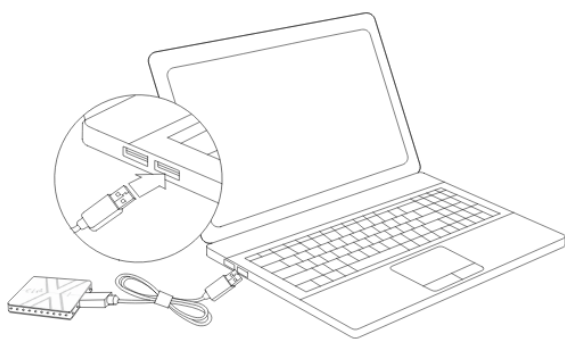

1



2

4. Press the "Add a New Cléxi" button.

5. Press the "Start" button.

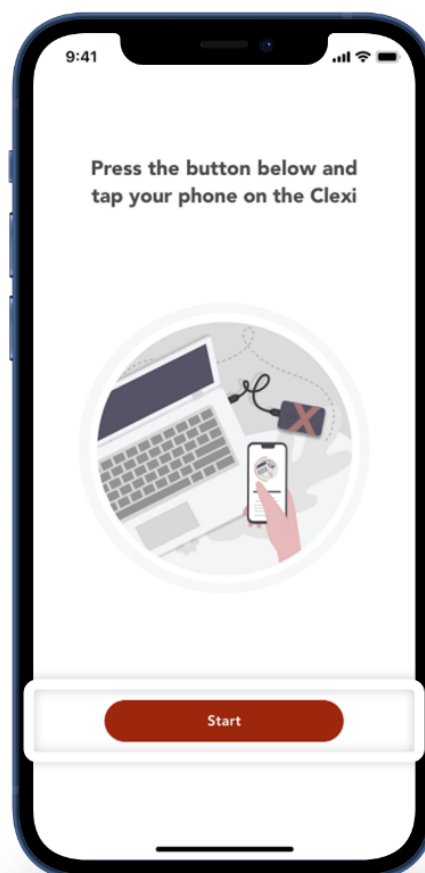

6. Bring your phone close to the drive and wait for the registration request.

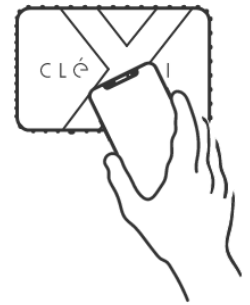

7. The app will ask for your Fingerprint, Face-ID or passcode (Depending on your phone's setting). Proceed with your preferred method. Do not close the app.



Use Face ID to  
unlock



Rest your finger on  
Touch ID



Enter your passcode  
to unlock

8. You can now unlock your drive.

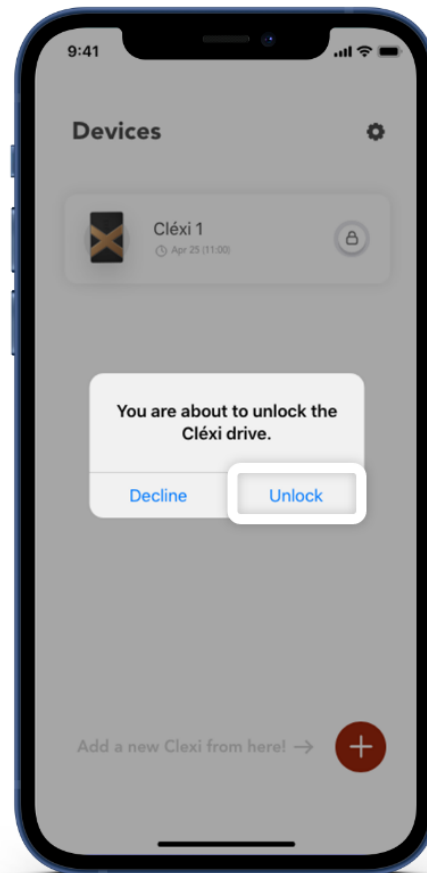
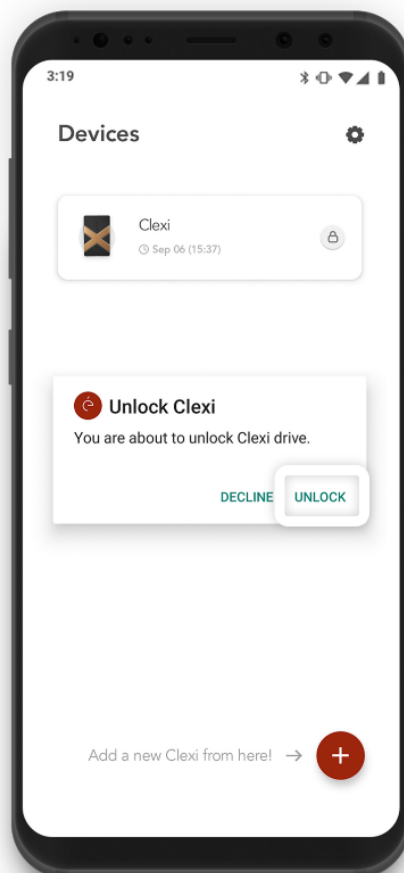

# Using Your Drive

1. Connect Cléxi to your device (laptop, tablet, TV, ...), the blue LEDs start blinking.

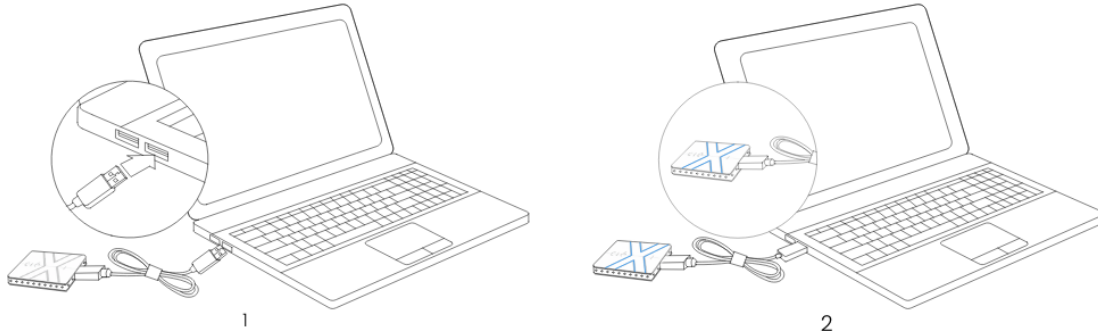

Hint: By pressing the button, the LEDs turn off after 10 seconds. To unlock, you need to press the button again.

2. Tap your phone on the drive.

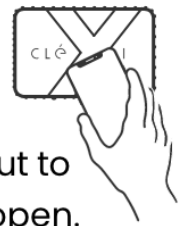

3. You will see the pop-up message on your phone "You are about to unlock the Cléxi drive". If you don't, make sure the Cléxi app is open.

4. Press the "Unlock" button.

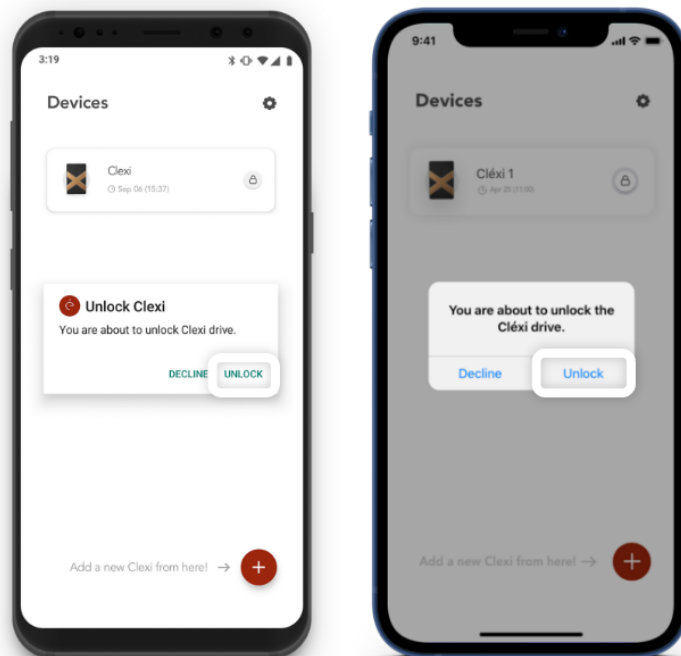

Hint: You don't even need to unlock your phone. Everything can be done on a lock screen.

5. Your Cléxi is now unlocked. The LED color turns green and you can access your data.

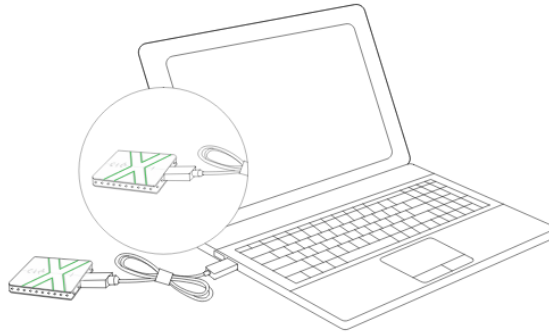

6. To lock the drive, just press the toggle button which indicates the lock/unlock status of your Cléxi.

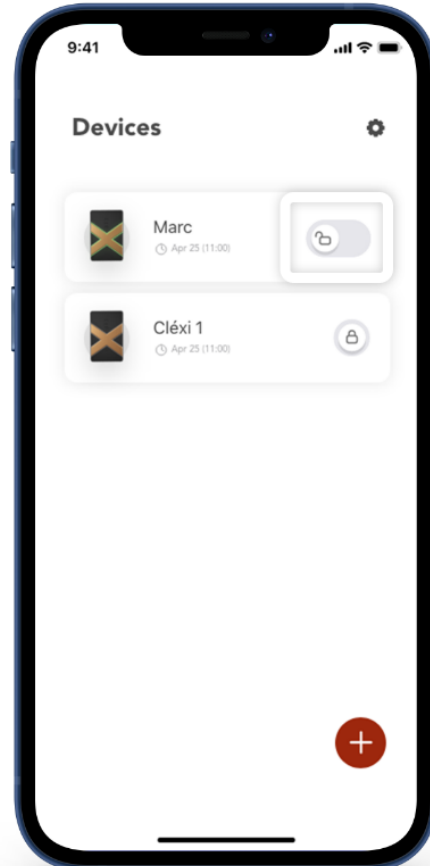

# LED Colors Meanings



## Blinking Red:

Cléxi drive is ready for the first time registration.

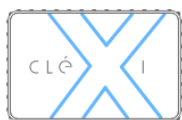

## Blinking Blue:

The Cléxi drive is locked and looking for your phone to be tapped.



## Solid Green:

The Cléxi drive is unlocked and ready to use, you must be able to see the volume in the connected device (Laptop, phone , ...).

# Hidden Button Functionality

By pressing the button, you can see the status of the drive. If it is unlocked, the green LEDs will turn on. If it is locked, the blue LEDs will start blinking and the drive seeks your phone to be tapped.

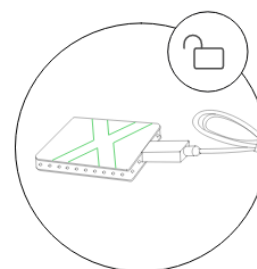
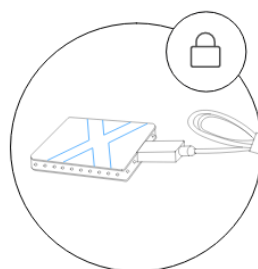
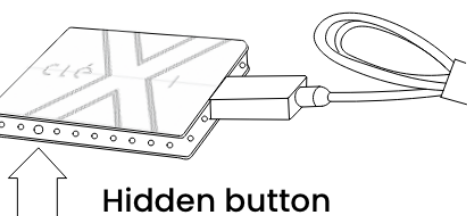

Once you plug your Cléxi, the blue LEDs start blinking indicating that it is looking for your phone. However, if you lock a drive or press the hidden button, the LEDs turn off and the drive stops looking. By pressing the button, the drive starts looking for your phone again.

# Features

## Turn Cléxi into a regular external drive

By default, Cléxi is a secured external drive and your data is only accessible when the drive is unlocked by your phone. However, it's possible to disable this feature and use your Cléxi as a regular none-secure external drive. You may change this mode on the drive setting page as shown below:

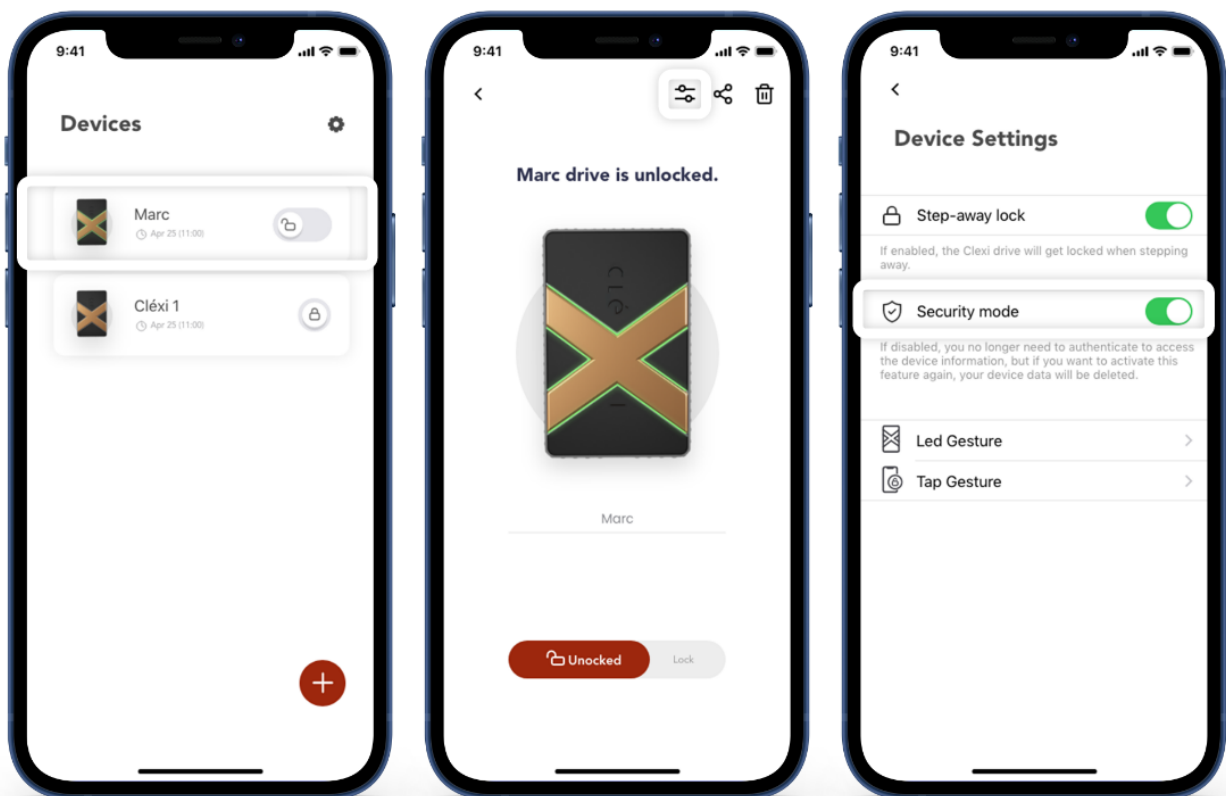

### CAUTION

CAUTION: IF YOU DISABLE THE SECURITY MODE, WHEN YOU DECIDE TO GO BACK TO SECURE MODE, ALL OF YOUR DATA ON YOUR DRIVE WILL BE ERASED.

You will need to initialize and format your drive using Disk utility in Mac OS or Disk Management in Windows.



## Remove from your account

You can remove a Cléxi drive from your account and get it ready for sale. Your data will be erased beyond recovery. After removing your Cléxi, anyone can register it with an account in the Cléxi app.

To remove, first unlock your Cléxi. Then, open the app, select your drive, tap on the delete button on the top of the page.

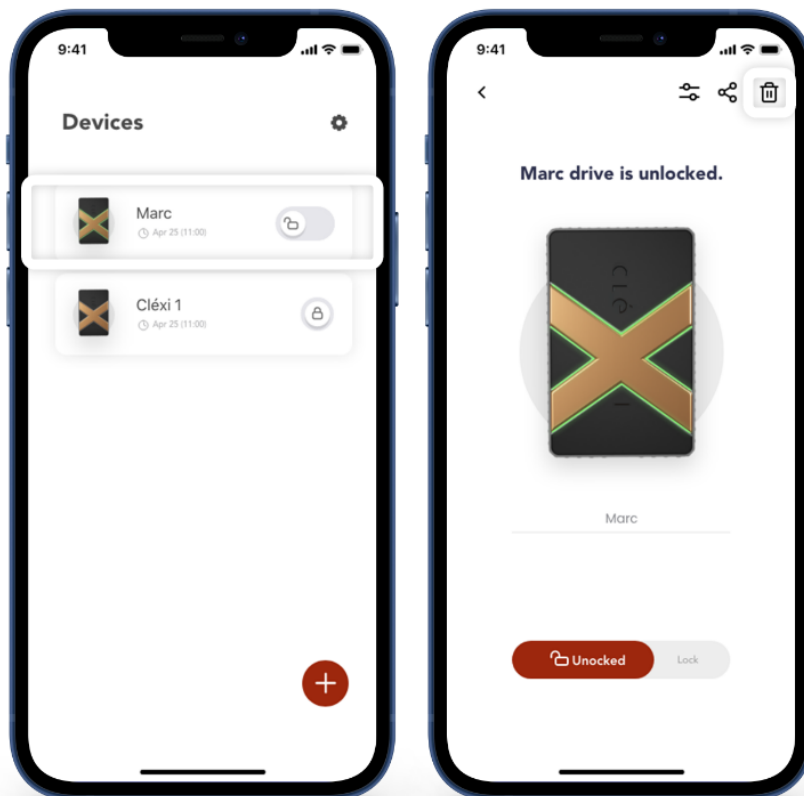

## Enable Step-away lock

This feature has been enabled by default. With this option, if you step away or move your phone away from Cléxi, it will get locked automatically. If you disable this feature, the Cléxi drive will remain unlocked even if you leave the vicinity.

To access this feature, in the Cléxi app, select the drive, tap on the setting icon on top of the page to go to the drive setting page. Note that this can only be changed when the drive is locked.

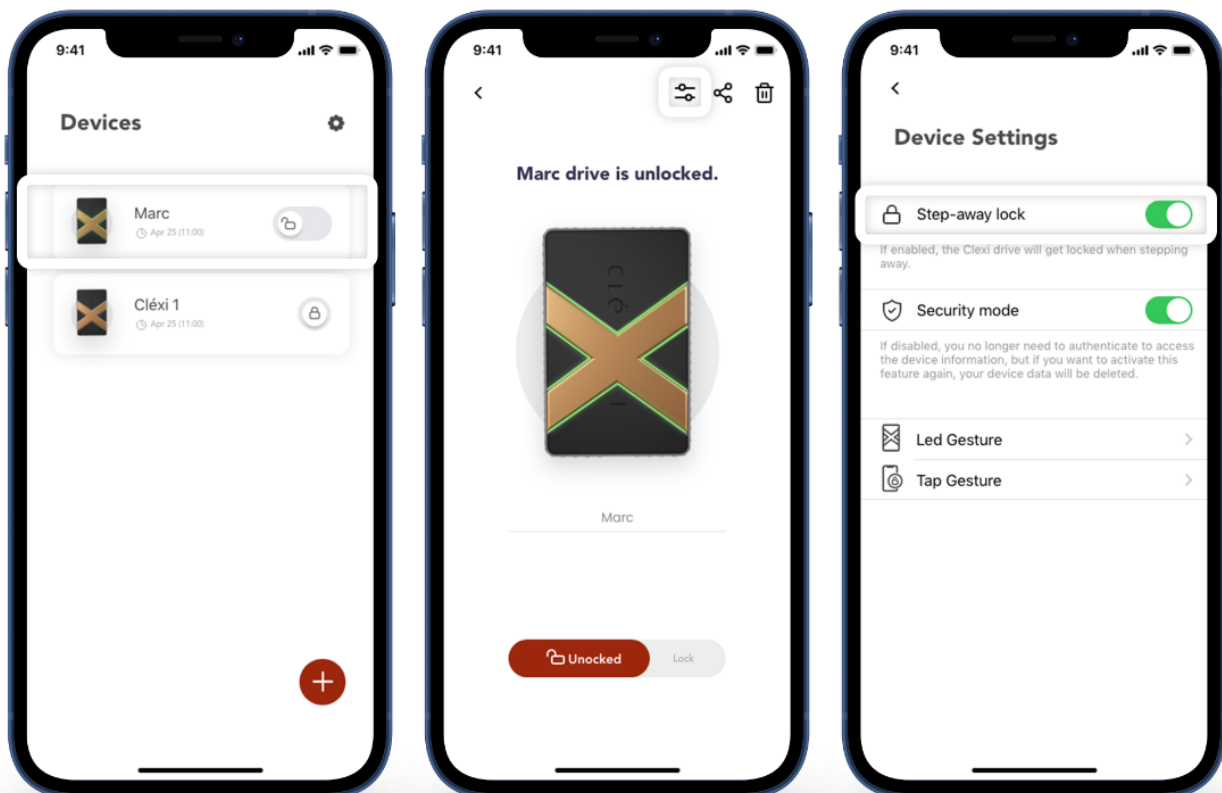

## Sharing

You can easily share your Cléxi drive with anyone. Follow the steps below:

1. Open your Cléxi app, select the drive that you want to share.
2. From top right of the page, tap on the share icon.

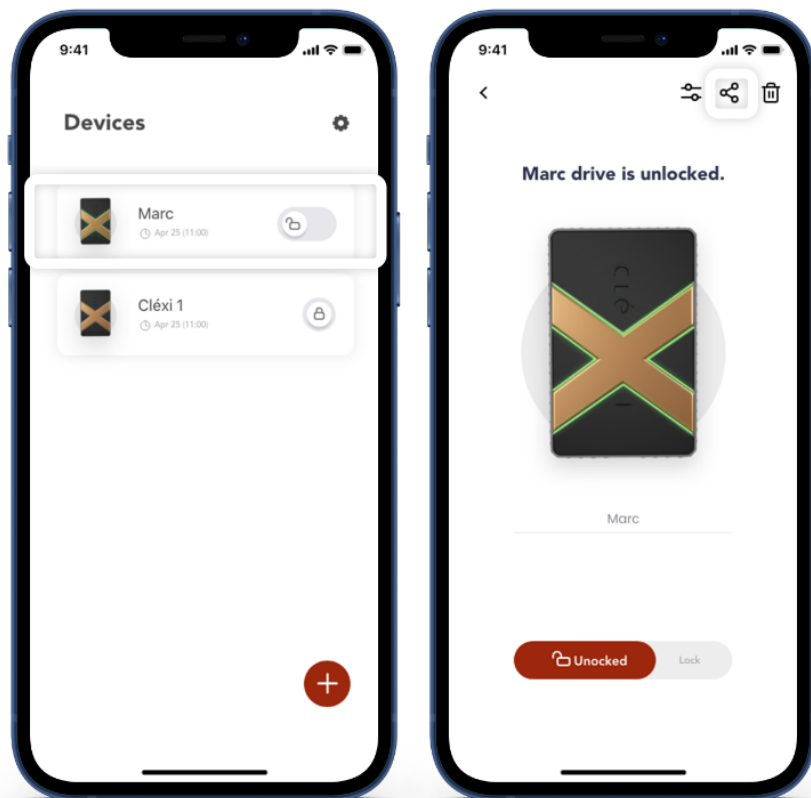

3. Follow the instructions in the app.
4. The recipient will receive an email with instructions on how to register the shared Cléxi and use it.

## Online Dashboard

After signing up in the Cléxi app, you can access Cléxi online dashboard (<https://panel.clexi.co>) to manage your Cléxi drive. You do not need this panel daily and your Cléxi app will be all you need, however, in some certain situations you may need to access this dashboard.

## How to contact us:

✉ [support@clexi.co](mailto:support@clexi.co)

Have you seen a bug? Please report it here

<https://airtable.com/shrL7o7Wxqgk17mjj>